

EC TYPE-APPROVAL CERTIFICATE

Communication concerning the

- type-approval ⁽¹⁾
- ~~extension of type approval~~ ⁽¹⁾
- ~~refusal of type approval~~ ⁽¹⁾
- ~~withdraw of type approval~~ ⁽¹⁾

of a type of a ~~vehicle/component~~/separate technical unit ⁽¹⁾ with regard to Directive 70/157/EEC, as last amended by Directive 2013/15/EU

Type-approval number:

e24*70/157*2007/34*2080*03

Reason for extension:

- 1 new variant will be added
- 2 new tail pipes variants will be added

SECTION I

- | | | |
|-------|--|---|
| 0.1 | Make (trade name of manufacturer): | MILLTEK |
| 0.2 | Type and general commercial description: | MSVW403-404
<i>(MSVW403 – Intermediate Silencer,
MSVW404 – Rear silencer
MSVW475 – Rear silencer)</i> |
| 0.3 | Means of identification of type if marked on the separate technical unit ⁽¹⁾ ⁽²⁾ : | Type shield |
| 0.3.1 | Location of that marking: | At the silencers, below |
| 0.4 | Category of vehicle ⁽³⁾ : | M1 |
| 0.5 | Name and address of manufacturer: | MILLTEK SPORT LTD,
Belfield Industrial Estate, Ilkeston,
GB-Derbyshire DE7 8DU. |
| 0.7 | In the case of components and separate technical units, location and method of affixing of the EC approval mark: | Type shield at the silencer below |
| 0.8 | Address(es) of assembly plant(s): | MILLTEK SPORT LTD,
Belfield Industrial Estate, Ilkeston,
GB-Derbyshire DE7 8DU. |

Type-approval number:

*e24*70/157*2007/34*2080*03*

SECTION II

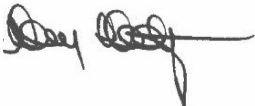
1. Additional information (where applicable): *See Addendum*
2. Technical Service responsible for carrying out the tests: *TÜV SÜD Auto Service GmbH,
Westendstraße 199,
D-80686 München,
Germany*
3. Date of test report: *16.07.2018*
4. Number of test report: *13-00171-VA-GBM-03*
5. Remarks (if any): *See Addendum*
6. Place: *Dublin*
7. Date: *29th August, 2018*
8. Signature: 
9. The index to the information package lodged with the approval authority, which may be obtained on request, is attached.
10. List of documents:
 1. Enclosure 1
 2. Enclosure 2
 3. Enclosure 3
 4. Technical report with annexes and drawings





concerning the separate technical unit type-approval of exhaust systems for motor vehicles with regard to Directive 70/157/EEC, as last amended by Directive 2013/15/EU

- | | | |
|-------|---|-----------------------|
| 1. | Additional information | |
| 1.1 | Composition of the separate technical unit: | (*) |
| 1.2 | Trade mark or trade name of the type(s) of motor vehicle to which the silencer is to be fitted ⁽¹⁾ | (*) |
| 1.3 | Type(s) of vehicle and its/their type-approval number(s): | (*) |
| 1.4 | Engine | |
| 1.4.1 | Type (positive ignition, diesel): | (*) |
| 1.4.2 | Cycles: two-stroke, four-stroke: | (*) |
| 1.4.3 | Total cylinder capacity: | (*) |
| 1.4.4 | Rated maximum engine power: | (*) kW |
| | - at: | (*) rev/min |
| 1.5 | Number of gear ratios: | (*) |
| 1.6 | Gear ratios employed: | (*) |
| 1.7 | Drive-axle ratio(s): | (*) |
| 1.8 | Sound level values | |
| | - moving vehicle: | (*) dB(A) |
| | speed stabilised before acceleration at: | (*) km/h |
| | - stationary vehicle: | (*) dB(A) |
| | at: | (*) rev/min |
| 1.9 | Value in back pressure: | (*) |
| 1.10 | Any restriction in respect of use and mounting requirements: | (*) |
| 5. | Remarks: | (*) = see Test Report |



concerning the type-approval of a vehicle with regard to Directive 70/157/EEC, as last amended by Directive 2013/15/EU

- 1. Additional information
- 1.1 If necessary, list of vehicles covered by item 3.1.2.3.2.3. of Annex III of UN/ECE Regulation No 51: N/A
- 1.2 Engine
- 1.2.1 Manufacturer: N/A
- 1.2.2 Type: N/A
- 1.2.3 Model: N/A
- 1.2.4 Rated maximum power :kW atmin-1: N/A
- 1.3 Transmission (non-automatic gearbox/automatic gearbox): N/A
- 1.3.1 Number of gears: N/A
- 1.4 Equipment
- 1.4.1 Exhaust silencer
- 1.4.1.1 Manufacturer: N/A
- 1.4.1.2 Model: N/A
- 1.4.1.3 Type..... in accordance with drawing No.: N/A
- 1.4.2 Intake silencer:
- 1.4.2.1 Manufacturer: N/A
- 1.4.2.2 Model: N/A
- 1.4.2.3 Type..... in accordance with drawing No.: N/A
- 1.5 Tyre size: N/A
- 1.5.1 Description of tyre type used for type-approval testing: N/A
- 1.6 Measurements
- 1.6.1 Sound level of moving vehicle: N/A

Measurement Results			
	Left-hand side dB(A) ⁽¹⁾	Right-hand side dB(A) ⁽¹⁾	Position of gear lever
First measurement			
Second measurement			
Third measurement			
Fourth measurement			
Test result: dB (A)/E ⁽²⁾			
⁽¹⁾ The measurement values are given with the 1 dB (A) deduction in accordance with provisions of item 2.2.1 of Annex I. ⁽²⁾ 'E' indicates that the measurements in question were conducted in accordance with this Directive.			



Type-approval number:

*e24*70/157*2007/34*2080*03*

1.6.2 Sound level of stationary vehicle:

N/A

Measurement Results		
	dB (A)	Engine
First measurement		
Second measurement		
Third measurement		
Test result: dB (A)/E ⁽¹⁾		
⁽¹⁾ 'E' indicates that the measurements in question were conducted in accordance with this Directive.		

1.6.3 Sound level of compressed air noise:

N/A

Measurement Results		
	Left-hand side dB(A) ⁽¹⁾	Right-hand side dB(A) ⁽¹⁾
First measurement		
Second measurement		
Third measurement		
Fourth measurement		
Test result: dB (A)		
⁽¹⁾ The measurement values are given with the 1 dB (A) deduction in accordance with provisions of item 2.2.1 of Annex I.		

5. Remarks:

N/A

Index to the Information Package

Date of issue:	<i>11th November, 2013.</i>
Date of latest amendment:	<i>29th August, 2018</i>
Reason for extension/revision:	<i>- 1 new variant will be added - 2 new tail pipes variants will be added</i>
1. Additional conditions, and advisory notes on legal alternatives	
2. Test report(s)	
- numbers(s):	<i>13-00171-VA-GBM up to 03</i>
- date of issue:	<i>21.10.2013</i>
- date of latest amendment:	<i>16.07.2018</i>
3. Information document	
- number(s):	<i>MSVW403-404/03</i>
- date of issue:	<i>21.10.2013</i>
- date of latest amendment:	<i>04.07.2018</i>
Documentation:	<i>16 pages</i>

Type-approval No:

e24*70/157*2007/34*2080*03

Appendix: **Additional conditions, and advisory notes on legal alternatives.**

A: Additional conditions:

1. The STU, Type *MSVW403-404* contains the following type approval mark:

e24	032080
-----	--------

The dimensions and proportions of this mark must correspond to the Directive.
All parts of the separate technical unit, other than the mounts and the exhaust pipe shall be legibly and durably labelled with the following information:

 - EC Type Approval mark
 - Manufacturer's trade description
 - Trademark or trade name of the manufacturer

As an alternative to using a plate for the above information, the information may be embossed on the silencer housing.
2. Mounting instructions shall be supplied with each unit, giving details of any limitations in the use of the silencer.
3. The silencer should be mounted in accordance with the mounting instructions.
4. The attached technical report, with any of its attachments, forms part of this Type Approval certificate.
5. Each individual product from series production shall be to the measurements specified in the attached drawings, and shall be manufactured only from the materials specified in the Approval documents.
6. Changes in the product are permitted only with the explicit permission of NSAI. Breaches of this requirement will lead to a withdrawal of the Type Approval, and in addition may be subject to criminal prosecution.
7. This Type Approval will expire when it is surrendered by the holder, or withdrawn by NSAI, or when the approved type of product no longer conforms to legal requirements. The recall of the Type Approval can be issued by NSAI when the conditions required for the issuing or continuation of the Type Approval are no longer current, or when the Approval holder is in breach of the duties attached to the Type Approval, or when it is established that the approved type no longer meets the requirements of traffic safety.
8. NSAI may at any time check the correct performance of the duties imposed by the grant of this Type Approval, and in order to do so, may make tests, or have tests made.
9. Changes in the company name, address or manufacturing site, as well as in any of the sales or other agents specified in the issuing of the approval must immediately be notified to the NSAI.
10. The duties imposed by the issuing of this certificate are not transferable. The legal protection of third parties is not affected by this certificate.
11. When the manufacture or sale of the vehicle, system, component or separate technical unit has not been started within one year of the date of issue of this certificate, then NSAI is to be informed. This requirement also applies when the manufacture or sale has been halted for more than one year, or when it ought to have been halted for more than one year. The initial commencement of manufacture or sale, or the resumption of manufacture or sale, shall then be notified to NSAI within one month of commencement or resumption.

B : Legal Options

Any objection to the requirements set out in this certificate shall be made within one month of the date of issue. The objection shall be made, in writing, to NSAI in Dublin.

**PRÜFBERICHT
ERWEITERUNG 03
TEST REPORT
EXTENSION 03**

Nr. / no. 13-00171-VA-GBM-03

über die Prüfung eines Ersatzauspuffsystems oder
eines Bauteils davon als selbständige technische Einheit gemäß

der Richtlinie des Rates der Europäischen Gemeinschaften zur Angleichung der Rechtsvorschriften der Mitgliedstaaten über den zulässigen Geräuschpegel und die Auspuffvorrichtung von Kraftfahrzeugen /

*about a test of an exhaust system or a component of
a type of separate technical unit for motor vehicles
in according to directive of the Council of the European Community for approximation of the
laws of the Member States relating to
the sound level and replacement silencers for motor vehicles*

Nr. 70/157/EWG vom 06.02.1970
einschließlich aller Änderungen bis
Nr. 2007/34/EG vom 14.06.2007 /

*No. 70/157/EEC dated 06.02.1970
including all amendments up to and including
No. 2007/34/EC dated 14.06.2007*

Genehmigungsstand / Approval status	
<input type="checkbox"/>	Erteilung einer Typgenehmigung <i>Granting of a type approval</i>
<input checked="" type="checkbox"/>	Nachtrag/Änderung zur Typgenehmigung Nr. e24*70/157*2007/34*2080*02 <i>Extension/correction to type approval no.</i>

Gründe der Erweiterung / *Reasons for extension*

Es wird geändert /
It will be changed:

Der Verwendungsbereich wird erweitert. /
Extension of application list

1 neue Variante wird hinzugefügt /

1 new variant will be added.

2 neue Endrohrvar. werden hinzugefügt /

2 new tail pipes variants will be added

Es wird aktualisiert /
It will be updated:

Anlagen 1/03 und 2/03 /

Enclosures 1/03 and 2/03

0. Allgemeine Angaben / *General information*

0.1. Fabrikmarke / *Make:*

MILLTEK SPORT

0.2. Typ / *Type:*

MSVW403-404

0.2.1. Varianten (Anzahl) /
Variants (numbers):

MSVW403-MSVW404,
MSVW403-MSVW475 (2)

0.4. Name und Anschrift des
Herstellers /
*Name and address of
manufacturer:*

MILLTEK SPORT LTD
Belfield Industrial Estate, Ilkeston
GB-Derbyshire DE7 8DU

0.5. Nr. der Beschreibungsmappe/
No. of information document:
Ausgabedatum / *Date:*

MSVW403-404
04.07.18

1. Beschreibung der Fahrzeuge, für
die die Einrichtung bestimmt ist /
*Description of the vehicles
the unit is used for:*

siehe Anlage 2/03 /
notice enclosure 2/03

2. Angaben zum Prüfobjekt / Composition of the separate technical unit

- 2.1. Art des Ersatzschalldämpfers /
Kind of replacement silencer: unverändert / *without changes*
- 2.2. Zusammensetzung der technischen
Einheit /
*Composition of the separate
technical unit:* siehe Anlage 1/03 / *notice enclosure 1/03*
- 2.3. Lage und Richtung des Endrohres /
*Position and direction of the
tail pipe:* unverändert / *without changes*

3. Prüfprotokoll / Test report

Auf erneute Prüfungen konnte verzichtet werden, da die neu hinzugekommenen Fahrzeuge serienmäßig mit der gleichen Schalldämpferanlage ausgerüstet sind und gleiche bzw. geringere Motorleistung besitzen und durch die bisherigen Messungen abgedeckt sind. /
New testing of the replacement silencer wasn't necessary because the new vehicles have in original the same exhaust system and same or lower maximum engine power and are covered by former tests.

4. Anlagen / Enclosures

Anlage 1/03 Teile der technischen Einheit (2 Seiten / *Pages*)
Enclosure 1/03 Composition of the separate technical unit

Anlage 2/03 Verwendungsbereich (1 Seite / *Page*)
Enclosure 2/03 Field of application

5. Schlußbescheinigung / Summary

Die unter Ziffer 0.5 erwähnte Beschreibungsmappe und der darin beschriebene Typ entsprechen der genannten Prüfgrundlage.

Der ungünstigste Fall wurde entsprechend Prozessbeschreibung „Erstellung von Gutachten“ bestimmt.

Der Prüfbericht darf nur vom Auftraggeber und nur in vollem Wortlaut vervielfältigt und weitergegeben werden. Eine auszugsweise Vervielfältigung und Veröffentlichung des Prüfberichtes ist nur nach schriftlicher Genehmigung des Prüflaboratoriums zulässig. /

The information folder stated at item 0.5 and the type described therein are in compliance with the test specification mentioned above.

The worst-case was selected in accordance with document "Preparation of Test Reports".

The test report may be reproduced and published in full and by the client only. It can be reproduced partially with the written permission of the test laboratory only.

Benannt als Technischer Dienst durch /
designated as Technical Service by:

Genehmigungsbehörde <i>Approval authority</i>	Land <i>Country</i>	Registriernummer <i>Registration number</i>
Kraftfahrt-Bundesamt (KBA)	Deutschland <i>Germany</i>	KBA-P 00100-10
Vehicle Certification Agency (VCA)	Vereinigtes Königreich <i>United Kingdom</i>	VCA-TS-006
Approval Authority of the Netherlands (RDW)	Niederlande <i>The Netherlands</i>	RDWT-082-XX
National Standards Authority of Ireland (NSAI)	Irland <i>Ireland</i>	Technical Service Number: 49

Dieser Bericht umfasst Seite 1 bis 4. /
This test report contains the pages 1 up to 4.

München, 16.07.18



Dipl.-Ing. (FH) M. Ebert
Sachverständiger / *Recognized Expert*
ebt
MSVW403-404_03.doc



Prüfbericht Nr. / Test report No.: 13-00171-VA-GBM-03
 Hersteller / Manufacturer: MILLTEK SPORT LTD
 Typ / Type: MSVW403-404



ANLAGE 1/03
ENCLOSURE 1/03

Teile der technischen Einheit + Originalteile/Ersatzteile = Gesamtauspuffanlage / Composition of the separate technical unit

Lfd. Nr. nach Zeichnung / No. see in drawing	Einzelteile, Abmessungen in mm / Components parts, dimensions in mm	Abmessungen des Teiles in mm bzw. Originalteil / Ersatzteil / Dimensions of the part in mm or original part / replacement part	Teilenummer bzw. Genehmigungsnummer / Part no. or homologation no.
1)	Katalysator / Catalytic converter	Originalteile / Original parts	-
2a)	Zwischenrohr / Intermediate pipe Ø 76,2	Ersatzteil / Replacement part	MSVW402REP
3a)	Mittelschalldämpfer / Intermediate silencer (Eintrittsrohr / Inlet pipe Ø 76,2 Austrittsrohr / Outlet pipe Ø 76,2)	oval LW LW / inside 280 x LW / inside 152 x 300 lg	MSVW403
4a)	Nachschalldämpfer / Rear silencer (Eintrittsrohr / Inlet pipe Ø 76,2 2 Austrittsrohre / Outlet pipes Ø 63,5)	trapezoid LW / inside 280 x LW / inside 127 x 750 lg	MSVW404
4b)	Nachschalldämpfer / Rear silencer (Eintrittsrohr / Inlet pipe Ø 76,2 2 Austrittsrohre / Outlet pipes Ø 63,5)	trapezoid LW / inside 280 x LW / inside 127 x 750 lg	MSVW475
5a)	2 Endrohre / Tail pipes Ø 100 (Zeichnung / drawing AT1136, AT1115)	Ersatzteile / Replacement parts	MSVW354 / MSVW355 / MSTIP123
5b)	2 Endrohre / Tail pipes oval 75 x 152 (Zeichnung / drawing AT1152)	Ersatzteile / Replacement parts	MSTIP172 / MSTIP173

Prüfbericht Nr. / Test report No.: 13-00171-VA-GBM-03
Hersteller / Manufacturer: MILLTEK SPORT LTD
Typ / Type: MSVW403-404



ANLAGE 1/03
ENCLOSURE 1/03

Teile der technischen Einheit + Originalteile/Ersatzteile = Gesamtauspuffanlage / Composition of the separate technical unit

Lfd. Nr. nach Zeichnung / No. see in drawing	Einzelteile, Abmessungen in mm / Components parts, dimensions in mm	Abmessungen des Teiles in mm bzw. Originalteil / Ersatzteil / Dimensions of the part in mm or original part / replacement part	Teilenummer bzw. Genehmigungsnummer / Part no. or homologation no.
5c)	4 Endrohre / Tail pipes \varnothing 80 (Zeichnung / drawing AT1161/1162)	Ersatzteile / Replacement parts	MSTIP186, MSTIP187 / MSTIP188, MSTIP189
5d)	2 Endrohre / Tail pipes \varnothing 100 (Zeichnung / drawing AT1094Ti)	Ersatzteile / Replacement parts	MSVW194
5e)	2 Endrohre / Tail pipes \varnothing 102 (Zeichnung / drawing AT1183)	Ersatzteile / Replacement parts	MSTIP226

MSVW403-404_13.doc

Prüfbericht Nr. / Test report No.: 13-00171-VA-GBM-03
 Hersteller / Manufacturer: MILLTEK SPORT LTD
 Typ / Type: MSVW403-404



ANLAGE 2/03
ENCLOSURE 2/03

Verwendungsbereich (Fahrzeugdaten) / Field of application

Lfd. Nr. Fahrzeug /	Hersteller /	Fabrikmarke /	Handelsbezeichnung /	Fahrzeugtyp (und Genehmigungsnummer) /	Fahrzeugklasse /	Motortyp (Verbrennungsverfahren) /	Art des Motors /	Hubraum in cm ³ /	Nennleistung in kW/min ⁻¹ /	Anordnung entspr. Anlage 1/03 lfd. Nr. /	
No. of vehicle	Manufacturer	Trade mark	Commercial description	Vehicle type (and no. of homologation)	Category of vehicle	Engine type (type of combustion)	Stroke	Engine capacity in cm ³	Rated maximum engine power in kW/min ⁻¹	Composition as shown in enclosure 1/03 no.	
laufende Nummer der Anlage zum EG-Typgenehmigungsbogen / No. addendum to EC Type-approval certificate											
		1.2.	1.3.			1.4.1.	1.4.2.	1.4.3.	1.4.4.		
1)	VOLKSWAGEN-VW (D)	VW	Golf	AU (e1*...*0623*)	M1	CHHA	Otto / spark ignition	4-Takt / 4-stroke	1984	169/4700	1)2a)3a)4a)5a) / 1)2a)3a)4b)5a) / 1)2a)3a)4b)5d) / 1)2a)3a)4b)5e) /
2)						CHHB				162/4500	
3)						CXDA					
4)						CJXE				195/5350	
5)	SEAT (E)	Seat	Leon	5F (e9*...*0094*)		CJXA			206/5600	1)2a)3a)4a)5a) / 1)2a)3a)4a)5b) / 1)2a)3a)4a)5c) /	
6) ¹⁾									-6000		
7)						CJXE			247/5600		
8)						CJXH			195/5360		
									-6600		
									213/5900		
									-6400		

¹⁾ mit Leistungssteigerung Fa. ABT / with improved performance by comp. ABT

Beschreibungsbogen Nr. MSVW403-404/03 betreffend die EG-Typgenehmigung als selbständige technische Einheit einer Auspuffvorrichtung für Kraftfahrzeuge (Richtlinie 70/157/EWG, zuletzt geändert durch die Richtlinie 2007/34/EG) / Information Document No. MSVW403-404/03 according to EC type approval as separate technical unit of exhaust systems for motor vehicles (Directive 70/157/EEC, as last amended by Directive 2007/34/EC)

Blatt / Page 1

0. Allgemeines / General informations

- 0.1. Fabrikmarke / *Make*: MILLTEK
- 0.2. Typ und allgemeine Handelsbezeichnung(en) / *Type and commercial designations*:
MSVW403-404
(MSVW403 - Intermediate silencer
MSVW404 - Rear silencer
MSVW475 - Rear silencer)
- 0.5. Name und Anschrift des Herstellers / *Name and address of manufacturer*:
MILLTEK SPORT LTD
Belfield Industrial Estate Ilkeston,
Derbyshire. DE7 8DU
- 0.7. Art und Ort der Kennzeichnung / *Kind and place of marking*:
Typschild auf der Unterseite der Schalldämpfer / *Type shield at the silencers below*
- 0.8. Anschrift(en) der Fertigungsstätten / *Address of making plant*:
siehe 0.5 / *see 0.5*

**1. Beschreibung des Fahrzeugs, für das die Einrichtung bestimmt ist /
*Description of the vehicles the unit is used for:***

- 1.1. Fabrikmarke / *Make*:
siehe Anlage 2 des Technischen Berichts /
see enclosure 2 of the test report
- 1.2. Typ und allgemeine Handelsbezeichnungen / *Type and commercial designations*:
siehe Anlage 2 des Technischen Berichts /
see enclosure 2 of the test report
- 1.3. Merkmale zur Typidentifizierung, sofern vorhanden / *Means of identification of type if marked*:
siehe Anlage 2 des Technischen Berichts /
see enclosure 2 of the test report
- 1.4. Fahrzeugklasse / *Category of vehicle*:
siehe Anlage 2 des Technischen Berichts /
see enclosure 2 of the test report

Beschreibungsbogen Nr. MSVW403-404/03 betreffend die EG-Typgenehmigung als selbständige technische Einheit einer Auspuffvorrichtung für Kraftfahrzeuge (Richtlinie 70/157/EWG, zuletzt geändert durch die Richtlinie 2007/34/EG) / Information Document No. MSVW403-404/03 according to EC type approval as separate technical unit of exhaust systems for motor vehicles (Directive 70/157/EEC, as last amended by Directive 2007/34/EC)

Blatt / Page 2

- 1.5. EG-Typgenehmigungsnummer in bezug auf den Geräuschpegel / *EC-homologation no. concerning the sound level:*

siehe Anlage 3 des Technischen Berichts / *see enclosure 3 of the test report*

2. Beschreibung dieser Einrichtung / *Description of technical unit:*

- 2.1. Beschreibung der Ersatzauspuffanlage mit Angabe der Anordnung / *Description of replacement exhaust system incl. composition:*

siehe Anlage 2 des Technischen Berichts / *see enclosure 2 of the test report*

- 2.2. Detaillierte Zeichnungen jedes Bauteils, aus denen Anordnung und Merkmale hervorgehen. In diesen Zeichnungen ist die für die vorgeschriebene Anbringung des EG-Typgenehmigungszeichens vorgesehene Stelle anzugeben / *Detailed drawings of every part to see composition and means. In these drawings the place of the type-approval-sign is to mark.*

Anlagen / Enclosures

Zeichnungsnr. / no. of drawing:

Datum / Date:

Zeichnung Gesamtanlage / *Drawing exhaust system:*

T0092	04.07.18
A1641	23.09.13
A1642	04.07.18
AT1094Ti	04.02.15
AT1115	25.08.11
AT1136	21.10.13
AT1183	21.02.17

04.07.18



Datum, Unterschrift / *Date, signature*

DRAWING No.
T0092

REV	DATE	REVISION DETAILS	SIGN
A	04/07/2018	SYSTEM DRAWING PRODUCED ON CAD	DST

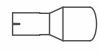
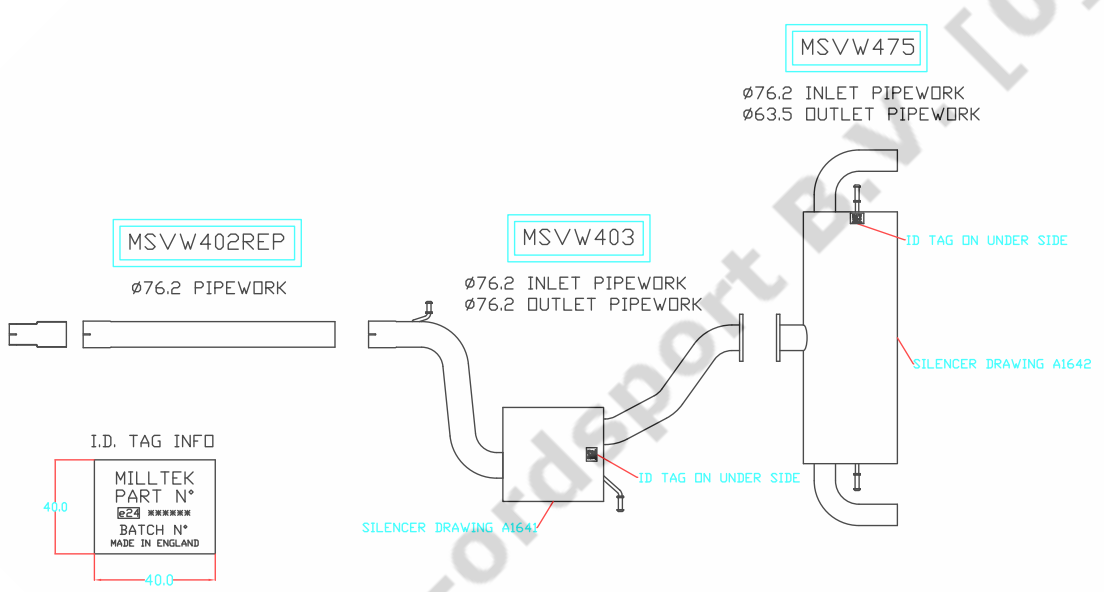

MSVW355 X 2
CERAMIC BLACK
MSVW354 X 2
POLISHED
REF: AT1136

MSTIP123 X 2
Ti
REF: AT1115

OR

MSVW476 X 2
CONN PIPE
+
MSTIP194 X 2
BURNT TI
REF: AT1094TI

MSTIP 226 X 2
CARBON
REF: AT1183

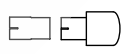

© This drawing is the property of Milltek Sport Ltd may only be used with permission.

MILLTEK SPORT LTD
BELFIELD INDUSTRIAL ESTATE
ILKESTON, DERBYSHIRE, DE7 8DU
TEL:-0115 8508690 FAX:-0115 9440366

ALL DIMENSIONS IN MM U. O. S.

GENERAL EXHAUST ARRANGEMENT

USED ON:- VW GOLF MK7.5 GTI

TOLERANCES
OPEN:- ±0.4
0.0:- ±0.25
0.00:- ±0.1

SCALE
1 : 1

DRAWN	DATE
DST	04/07/18

DRAWING No.
T0092

e24*70/157*2007/34*2080*03

DRAWING No.
A1641

REV	DATE	REVISION DETAILS	SIGN
A	23/09/2013	SILENCER DRAWING PRODUCED ON CAD	DJM

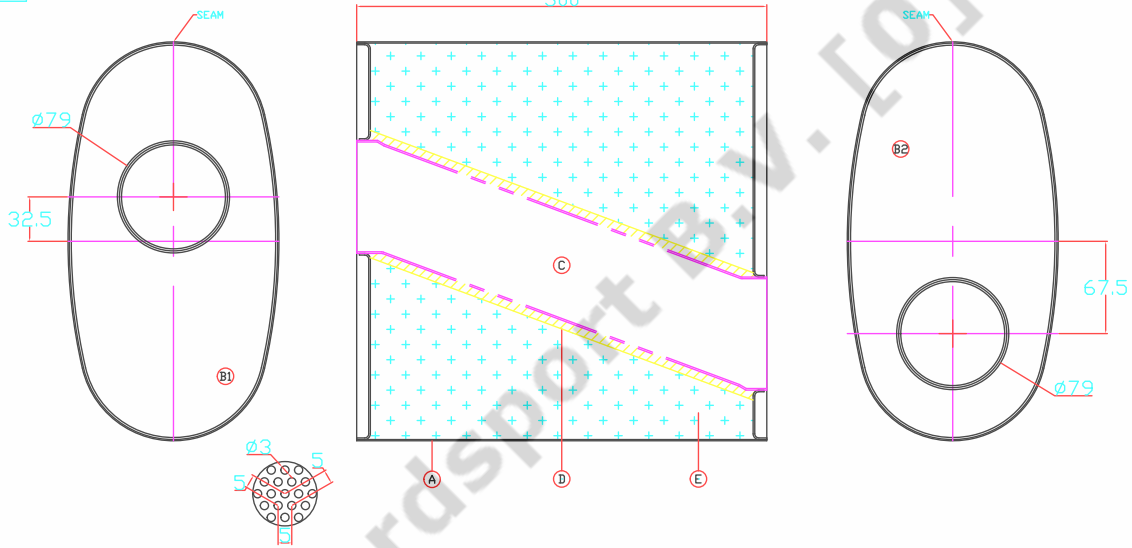

PERF DETAIL
 Ø3.0 HOLES ON A 5.0 TRIANGULAR PITCH
 6011 PATTERN - 32% OPEN AREA

PRODUCTION
RELEASE

APPROVED FOR PRODD BY.....

© This drawing is the property of Milltek Sport Limited and may only be used with permission.

MILLTEK SPORT LIMITED
 BELFIELD INDUSTRIAL ESTATE
 ILKESTON, DERBYSHIRE, DE7 8DU
 TEL:-0115 8508690 FAX:-0115 9440366

ITEM	DESCRIPTION	PART No	QTY	MATL	SIZE	FORM
E	ECR CE FIBRE	ECRCEFIBRE	1	-	MAXIMUM 1410G	FILL CHAMBER WITH MIN 1280G / MAX 1410G
D	WIREWOOL	SSWIREWOOL	1	304	AS REQUIRED	WRAP AROUND PERF TUBE & SPOTWELD IN PLACE
C	PERF TUBE	300012304P	1	304	Ø76.2 X 320 X 1.2	CUT 20° MITRE BOTH ENDS. SIZE BOTH ENDS TO 76.5 ID X 15MM LONG
B2	ENDPLATE	F9134	1	304	280 X 152 X 1.5	'BOUGHT IN' COMPONENT
B1	ENDPLATE	F9133	1	304	280 X 152 X 1.5	'BOUGHT IN' COMPONENT
A	SILENCER BODY	25120934BA	1	304	300 X 750 X 0.9	NDTCH, ROLL & SEAM

PART NUMBER: MSVW403

CENTRE SILENCER ASSEMBLY

USED ON:- VW GOLF 7 GTI

ALL DIMENSIONS IN MM U. O. S.

TOLERANCES	SCALE	DRAWN	DRAWING No.
OPEN:- ±0.4	1 : 1	DJM	A1641
0.0:- ±0.25	THIRD ANGLE	DATE	
0.00:- ±0.1		23/09/13	

e24*70/157*2007/34*2080*03

DRAWING No.
A1642

PRODUCTION
RELEASE

REV	DATE	REVISION DETAILS	SIGN
A	23/09/2013	SILENCER DRAWING PRODUCED ON CAD	DJM
B	04/07/2018	MSVW475 PART NUMBER ADDED TO INFORMATION	DST

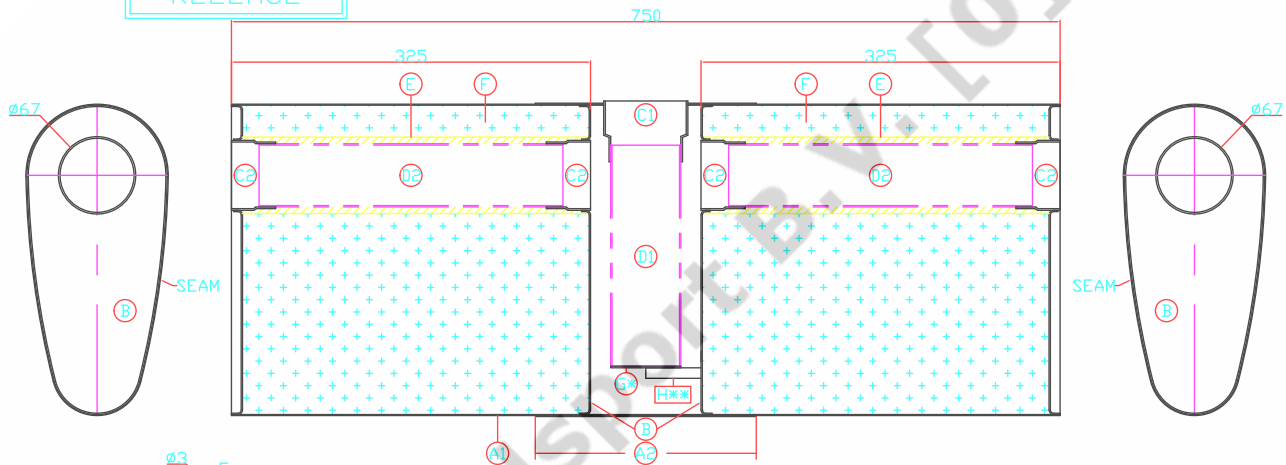

* WELD BLANKING PLATE TO END OF INLET PERF
** WELD SUPPORT BAR TO INLET PERF & BAFFLE

PERF DETAIL
Ø3.0 HOLES ON A 5.0 TRIANGULAR PITCH
6011 PATTERN - 32% OPEN AREA

APPROVED FOR PRODD BY.....

© This drawing is the property of Milltek Sport Limited and may only be used with permission.

MILLTEK SPORT LIMITED
BELFIELD INDUSTRIAL ESTATE
ILKESTON, DERBYSHIRE, DE7 8DU
TEL:-0115 8508690 FAX:-0115 9440366

ITEM	DESCRIPTION	PART No	QTY	MATL	SIZE	FORM
H	SUPPORT BAR	225012304P	1	304	Ø9.5 X 50	WELD BETWEEN INLET PERF AND BAFFLE PLATE FOR SUPPORT
G	BLANKING PLATE	F20197	1	304	Ø63.5 X 1.2	WELD TO END OF INLET PERF
F	ECR CE FIBRE	ECRCEFIBRE	2	304	MAXIMUM 1360G	FILL EACH CHAMBER WITH MIN 1230G / MAX 1360G
E	WIREWOOOL	SSWIREWOOOL	2	304	AS REQUIRED	WRAP AROUND PERF TUBE & SPOTWELD IN PLACE
D2	OUTLET PERF TUBE	225012304P	2	304	Ø57.15 X 275 X 1.2	-
D1	INLET PERF TUBE	250012304P	1	304	Ø63.5 X 200 X 1.2	-
C2	OUTLET SLEEVE	237515304	4	304	Ø60.3 X 40 X 1.5	SIZE ONE END TO 63.5 I.D X 20MM LONG
C1	INLET SLEEVE	275015304	1	304	Ø70.0 X 55 X 1.5	REDUCE ONE END TO 63.5 I.D. X 20MM LONG. SIZE OPP END TO 76.5 I.D
B	ENDPLATE	F9057	4	304	280 X 127 X 1.5	BOUGHT IN PART
A2	OUTER BODY	25120934BA	1	304	200 X 700 X 0.9	CNC PLASMA INLET HOLE, ROLL & SEAM
A1	SILENCER BODY	25120934BA	1	304	700 X 750 X 0.9	NOTCH, CNC PLASMA HOLE TO DRAWING SB1642MAIN

PART NUMBER: MSVW404, MSVW475		ALL DIMENSIONS IN MM U. O. S.	
REAR SILENCER ASSEMBLY		TOLERANCES	SCALE 1:1
USED ON:- VW GOLF 7 GTI		OPEN:- ±0.4	DRAWN DJM
		0.0:- ±0.25	DATE 23/09/13
		0.00:- ±0.1	THIRD ANGLE
			DRAWING No. A1642

e24*70/157*2007/34*2080*03

DRAWING No.
AT1094Ti

REV	DATE	REVISION DETAILS	SIGN
A	30/06/2011	TRIM DRAWING PRODUCED ON CAD	DJM
B	04/02/2015	ADDITIONAL FINISH INFO ADDED	DJM

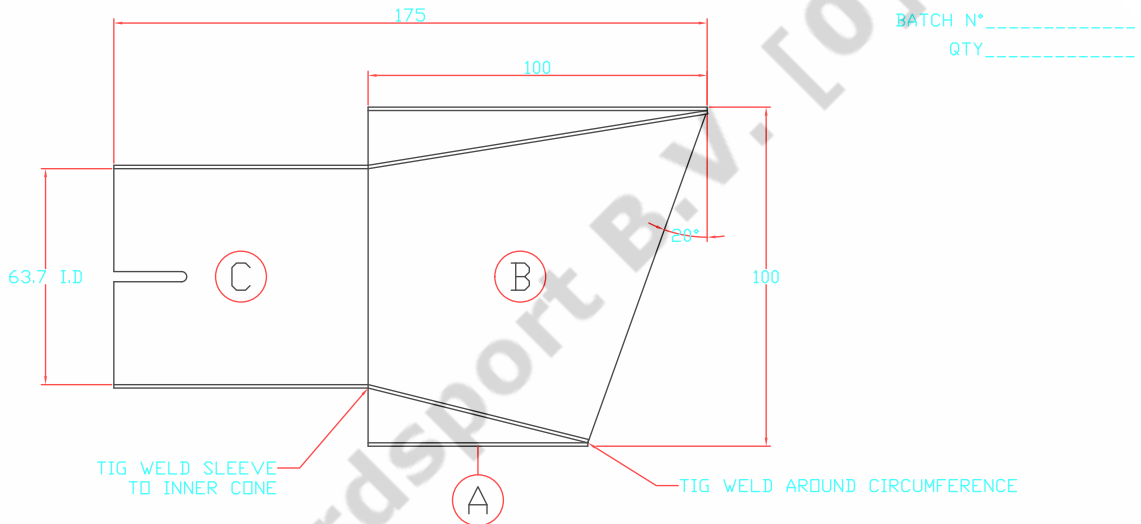

PART No	FINISH	REFERENCE
AT1094TI	BRUSHED	MSVW374
AT1094TIXX	"BURNT"	MSTIP194

PRODUCTION
RELEASE

APPROVED FOR PROD BY.....

© This drawing is the property of MILLTEK SPORT LTD and may only be used with permission.

MILLTEK SPORT LTD
BELFIELD INDUSTRIAL ESTATE
ILKESTON, DERBYSHIRE, DE7 8DU
TEL:-0115 8508690 FAX:-0115 9440366

ITEM	DESCRIPTION	PART No	QTY	MATL	SIZE	FORM
C	SLEEVE	-	1	Ti	SEE DETAIL	SIZE TO 63.7 ID & SLOT X 4
B	INNER CONE	-	1	Ti	1.0 THK SHEET	FORM LASER PROFILE
A	TRIM BODY	-	1	Ti	1.0 THK SHEET	FORM LASER PROFILE
ALL DIMENSIONS IN MM U. O. S.						
GT-100 STYLE TITANIUM TIP						TOLERANCES OPEN:- ±0.4 0.0:- ±0.25 0.00:- ±0.1
USED ON:- *						SCALE 1 : 1 THIRD ANGLE
						DRAWN DJM DATE 30/06/11
						DRAWING No. AT1094Ti

e24*70/157*2007/34*2080*03

DRAWING No. AT1115	PRODUCTION RELEASE	REV	DATE	REVISION DETAILS	SIGN
		A	25/08/2011	TRIM DRAWING PRODUCED ON CAD	DJM

BATCH N° _____
QTY _____

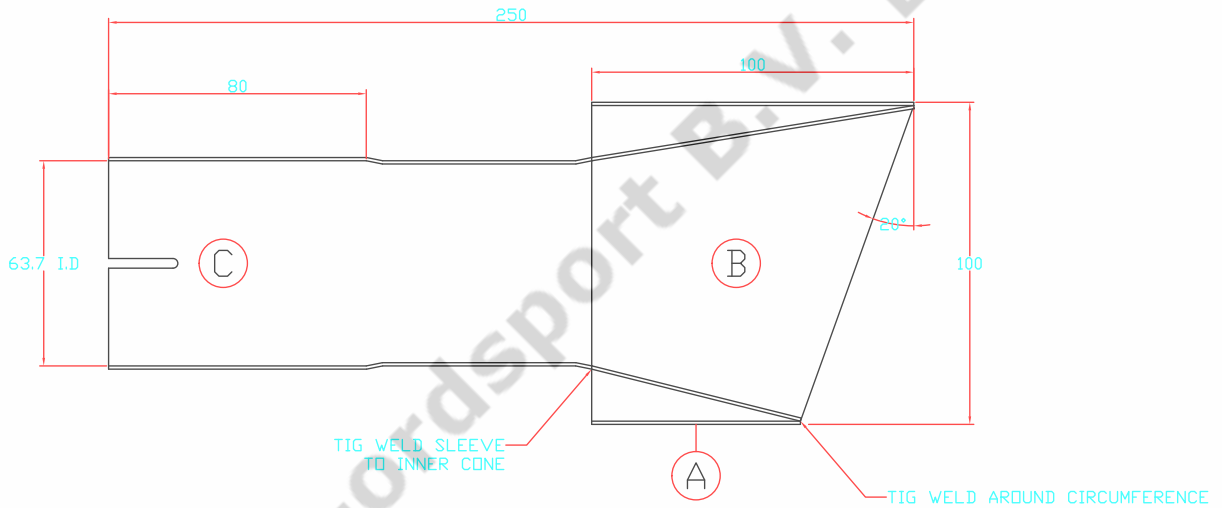

APPROVED FOR PROD BY.....

© This drawing is the property of MILLTEK SPORT LTD and may only be used with permission.

MILLTEK SPORT LTD
BELFIELD INDUSTRIAL ESTATE
ILKESTON, DERBYSHIRE, DE7 8DU
TEL:-0115 8508690 FAX:-0115 9440366

C	SLEEVE	-	1	TI	SEE DETAIL	SIZE TO 63.7 ID & SLOT X 4		
B	INNER CONE	-	1	TI	1.0 THK SHEET	FORM LASER PROFILE		
A	TRIM BODY	-	1	TI	1.0 THK SHEET	FORM LASER PROFILE		
ITEM	DESCRIPTION	PART No	QTY	MATL	SIZE	FORM		
ALL DIMENSIONS IN MM U. O. S.								
GT-100 STYLE TITANIUM TIP					TOLERANCES	SCALE	DRAWN	DRAWING No.
USED ON:- MSTIP123					OPEN:- ±0.4	1 : 1	DJM	AT1115
					0.0:- ±0.25	THIRD ANGLE	DATE	
					0.00:- ±0.1		25/08/11	

e24*70/157*2007/34*2080*03

DRAWING No.
AT1136

PRODUCTION
RELEASE

REV	DATE	REVISION DETAILS	SIGN
A	21/10/13	TRIM DRAWING PRODUCED ON CAD	DJM

BATCH N° _____
QTY _____

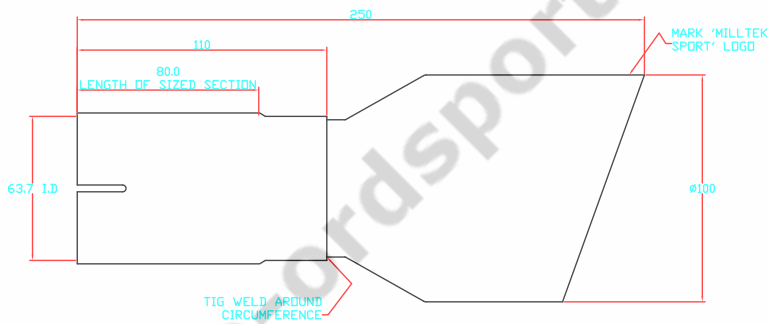
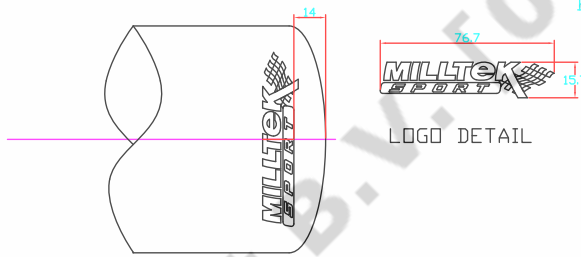
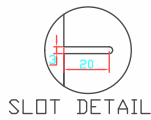

PART No	MSTIP No	FINISH
MSVW354	MSTIP112	POLISH
MSVW355	MSTIP113	BLACK
MSVW361	MSTIP113	BLACK

SIMILAR CONSTRUCTION TO AT1094

APPROVED FOR PROD BY.....

© This drawing is the property of
MILLTEK SPORT LTD and
may only be used with permission.

MILLTEK SPORT LTD
BELFIELD INDUSTRIAL ESTATE
ILKESTON, DERBYSHIRE, DE7 8DU
TEL:-0115 8508690 FAX:-0115 9440366

ITEM	DESCRIPTION	PART No	QTY	MATL	SIZE	FORM
ALL DIMENSIONS IN MM U. O. S.						
GT-100 TIP ASSY						TOLERANCES OPEN:- ±0.4 0.0:- ±0.25 0.00:- ±0.1
USED ON:- SEE CHART						SCALE 1 : 1 THIRD ANGLE
						DRAWN DJM DATE 21/10/13 DRAWING No. AT1136

e24*70/157*2007/34*2080*03

DRAWING No.
AT1183

PRODUCTION
RELEASE

REV	DATE	REVISION DETAILS	SIGN
A	21/02/2017	TRIM DRAWING PRODUCED ON CAD	DJM

© This drawing is the property of Milltek Sport Limited and may only be used with permission.

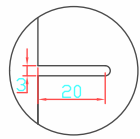

SLOT DETAIL (X4)

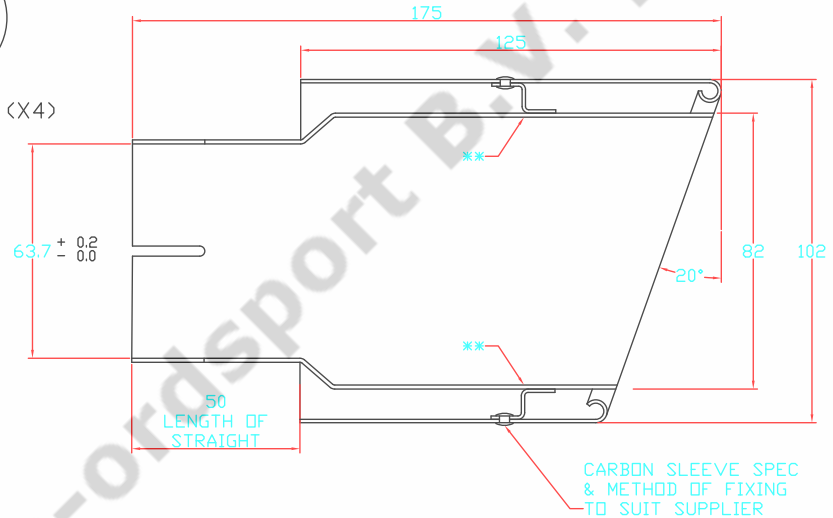

** - INTERNAL SURFACES OF INNER TUBE TO BE BLACK FINISH
FINISHED PART No - MSTIP226

APPROVED FOR PROD BY.....

MILLTEK SPORT LIMITED
BELFIELD INDUSTRIAL ESTATE
ILKESTON, DERBYSHIRE. DE7 8DU
TEL:-0115 8508690 FAX:-0115 9440366

DIMENSIONS IN mm U. O. S.		TOLERANCES	SCALE	DRAWN	DRAWING No.
100MM JET -CARBON TIP ASSY		OPEN:- ±0.4	1 : 1	DJM	AT1183
USED ON:-VARIOUS		0.0:- ±0.25	THIRD ANGLE	DATE	
		0.00:- ±0.1		21/02/17	

e24*70/157*2007/34*2080*03